

Scanning Stage SCAN^{plus} IM 120 × 80 for Olympus IX85

Specifications

Travel range	max. 120 × 80 mm
Travel speed	max. 120 mm/s (with 2 mm ball screw pitch)
Repeatability	< 1 µm ¹ (bidirectional)
Accuracy	±1 µm ¹
Resolution	0.05 µm (smallest step size)
Orthogonality	< 10 arcsec
Motor type	2-phase stepper motor
Limit switches	wear-free Hall sensors
Material	aluminium
Surface	anodic coating, black lacquered
Weight	approx. 7.1 kg

Order Information

Order No.: 48-4524-0502-0000

Product Features

- ▶ integrated linear measuring systems for highest accuracy
- ▶ flat, ergonomic design with rounded corners
- ▶ plain surface for easy cleaning
- ▶ integrated stationary connecting cables between scanning stage and controller, cable length: 2 m
- ▶ integrated electronic stage identification device ETS for automatic identification of the scanning stage and parametrization of the controller
- ▶ **5 years guarantee**, if the scanning stage is operated in the system with the Märzhäuser TANGO controller

Dimensions

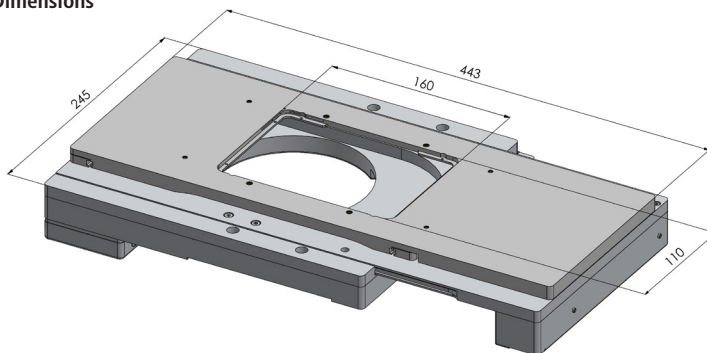

Accessories

Various Piezo Z-stages
 with travel ranges up to 500 µm

Various stage inserts
 with dimensions 160 × 110 × 8 mm

For more products please visit:
www.marzhauser.com